

PROFILE
Scale: Vert. 1"=20'
Horiz. 1"=40'

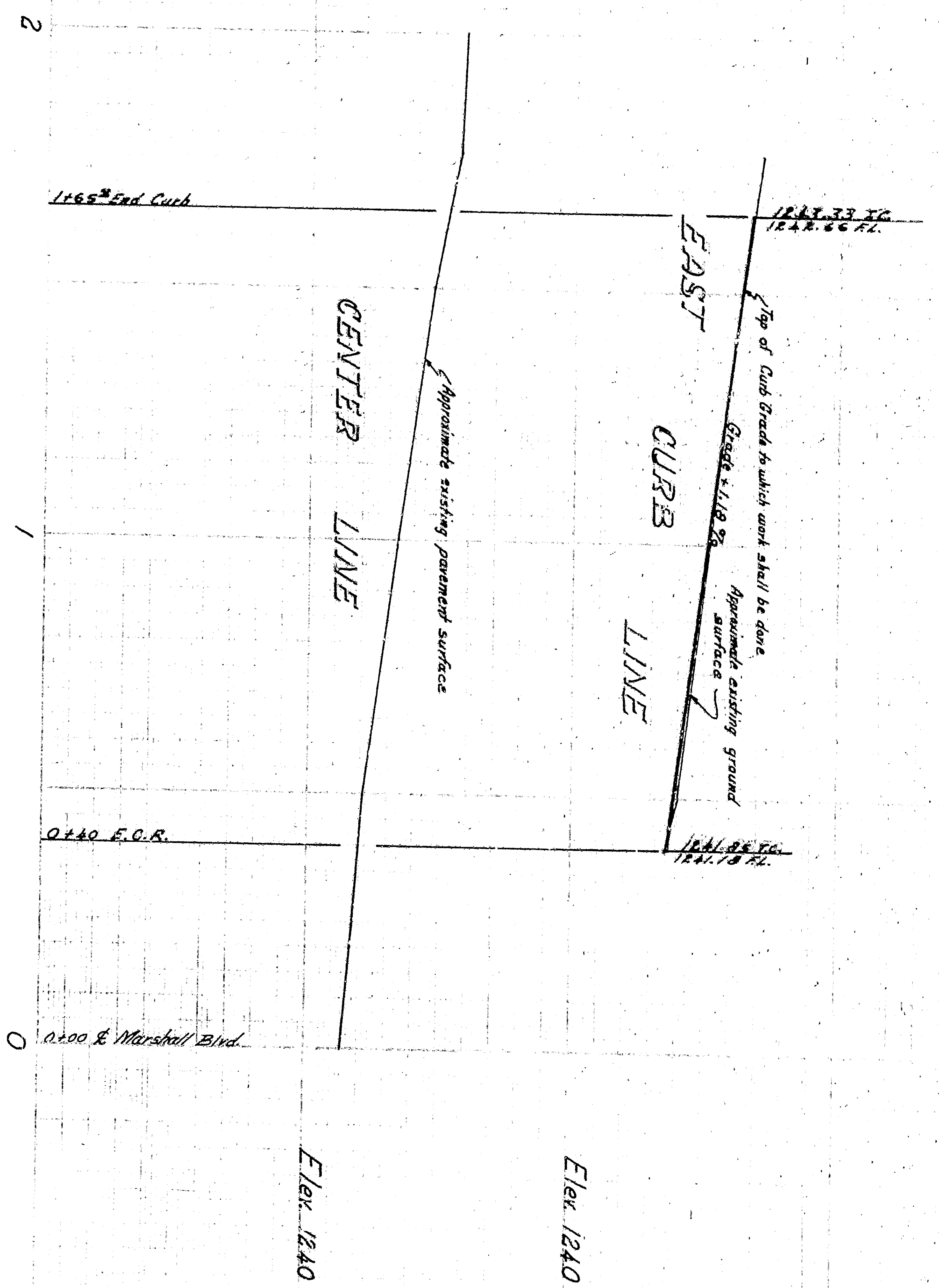

PLAN
Scale: 1"=20'

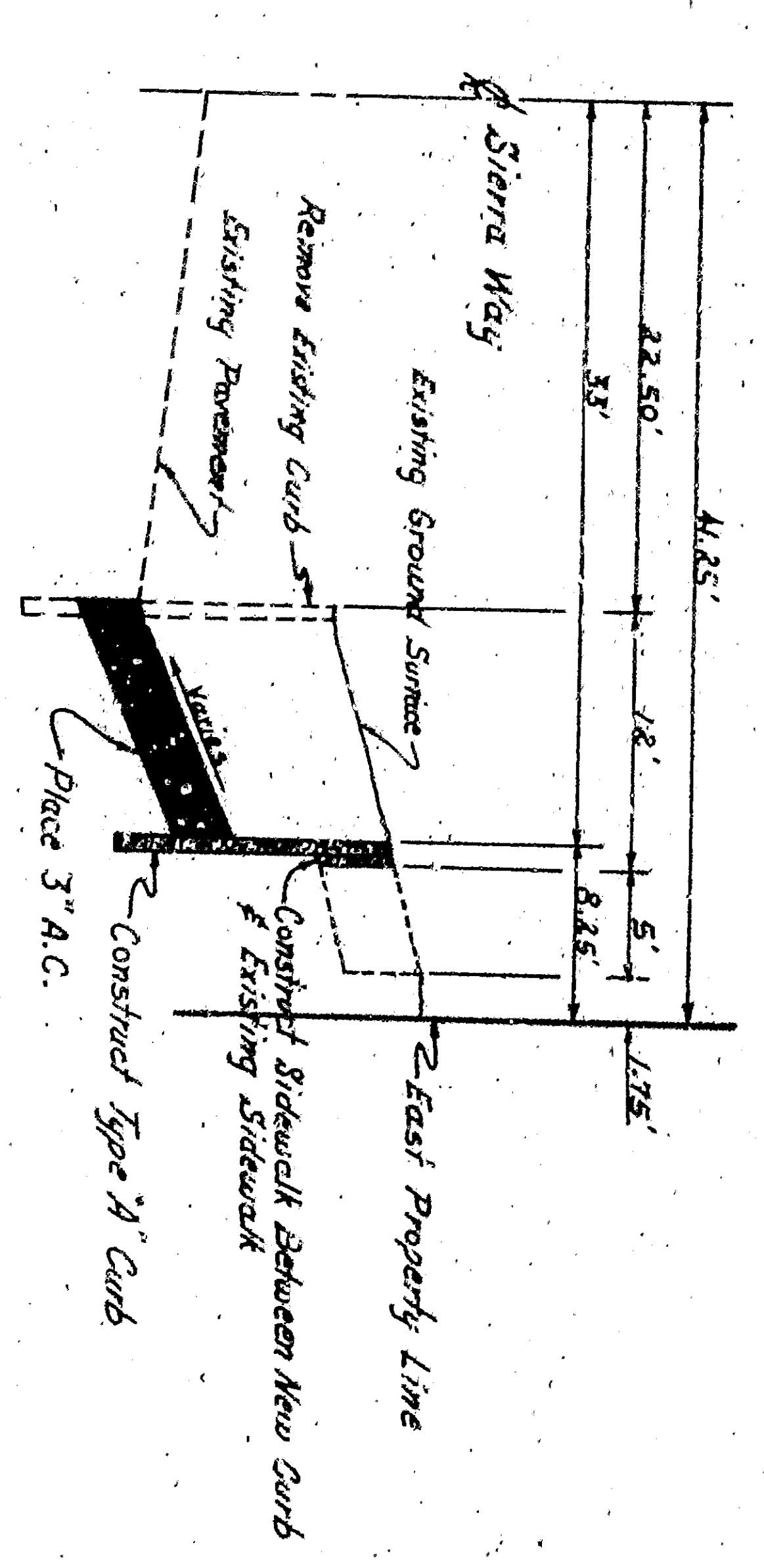
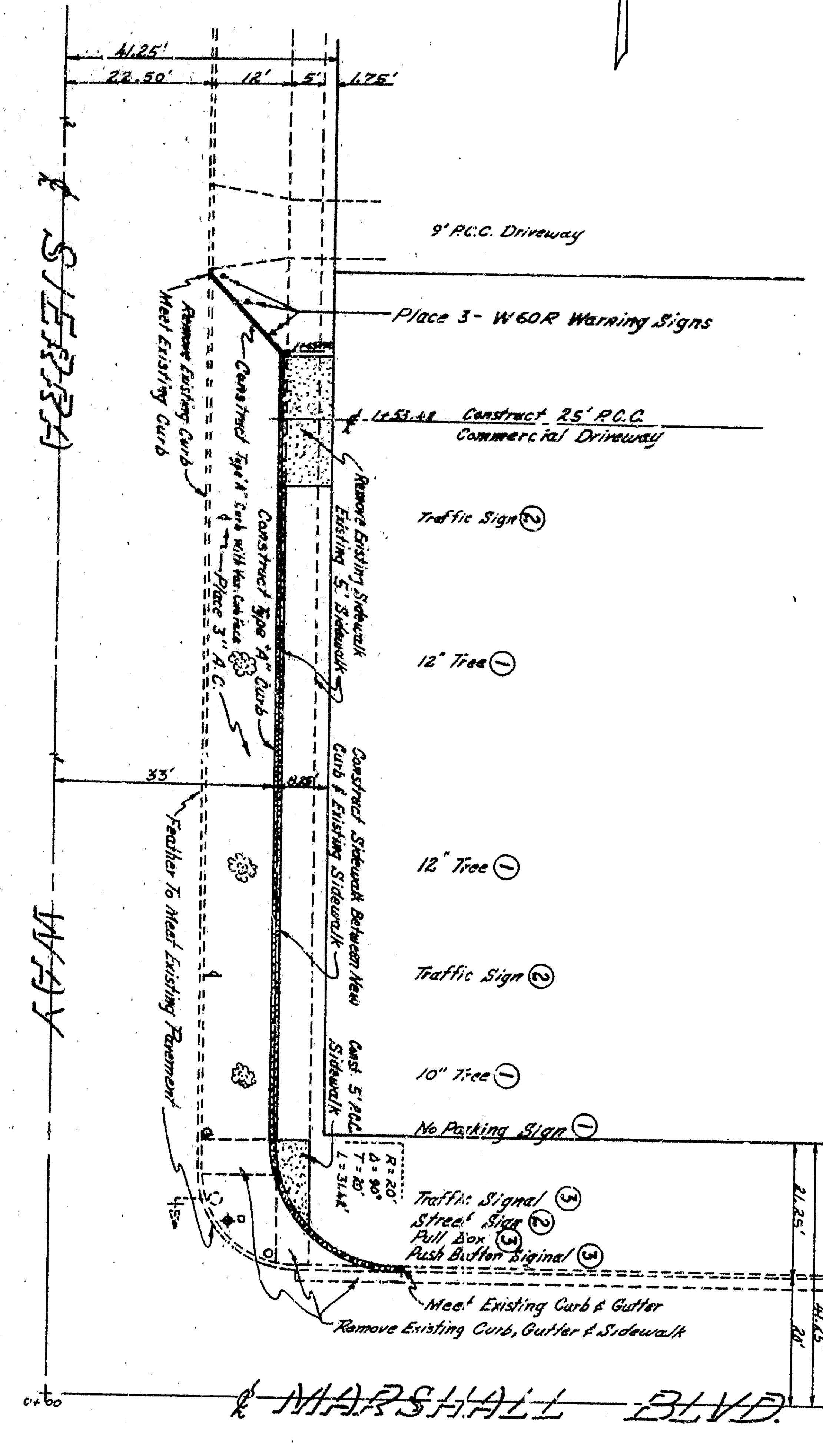

TYPICAL X SECTION
Scale: Vert. 1"=10'
Horiz. 1"=10'

BENCH MARK
Screw S/E Corner Marshall Blvd
and Sierra Way. Elev. 1241.18 M.S.L.
Scale: 1"=20'

GENERAL NOTES

- All work constructed on this plan shall conform to the specifications and standards of the State of California, Department of Transportation, Division of Highways, Standard Specifications, dated July 1964.
- Observe existing conditions on site.
- To be removed or relocated under this contract, existing or proposed signs shall be classed as follows:
 - To be removed or relocated by others.
 - To be removed or relocated by others.
 - To be removed or relocated by others.

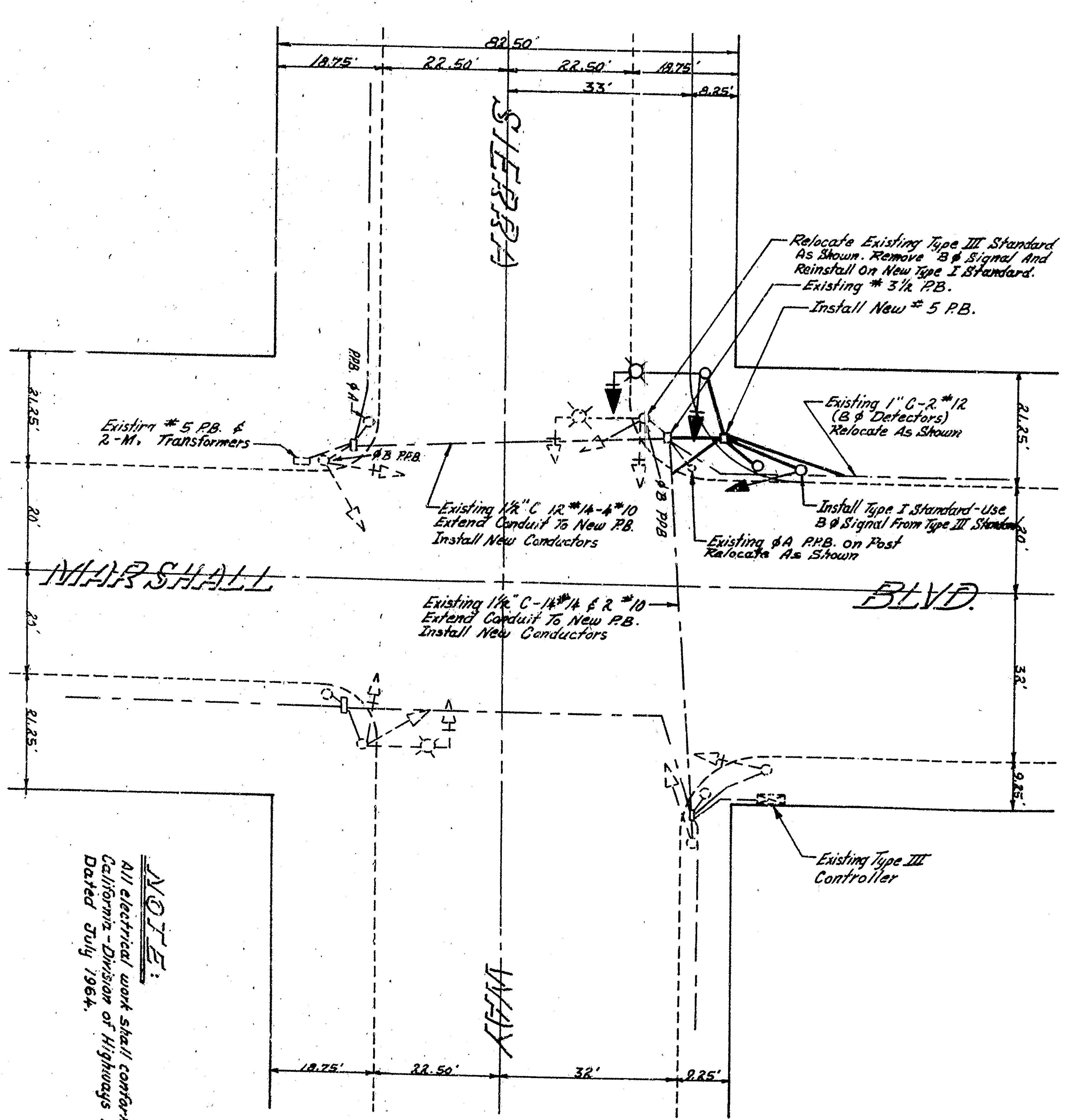

NOTE:
All electrical work shall conform to State of California - Division of Highways Standard Specifications, dated July 1964.

TRAFFIC SIGNAL RELOCATION PLAN
Scale: 1"=20'

APPROVED	DATE	1942
CITY ENGINEER		
REGISTERED CIVIL ENGINEER NO. 12553		
DRAWING NO. DRAWN BY		
3654		
CHECKED BY		
1 SHEET		
1 SHEETS		

DEPARTMENT OF ENGINEERING
CITY OF SAN BERNARDINO
WIDENING
NORTH-EAST CORNER
SIERRA WAY AND MARSHALL BLVD.